

MRE-6001

Nova Electric Mirror W20 X H30" CRI 90 CCT (K) 5000 1035 Lumens

LED Mirror Light

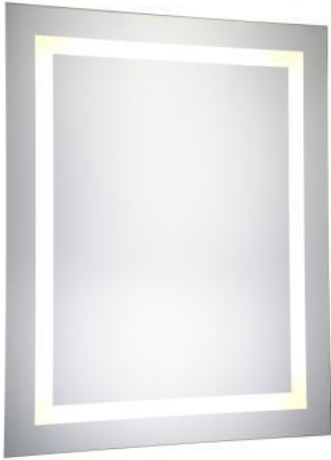
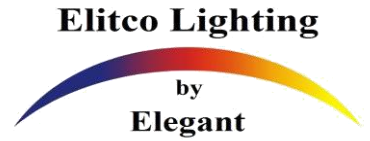

Project

Location

PRODUCT DESCRIPTION

IP44 Rated LED Backlit Bathroom Wall Mirror, Highly polished silver mirror with 4 Rectangle light windows. Epoxy powder coated mild steel back box. LED Mirror Light is designed to provide 40,000 hours of life.

SPECIFICATIONS:

- Mirror Size: W20" X H30" X D1.58"
- Lamp power: 15W;
- Lumens: 1035lm
- CRI \geq 0.9;
- CCT: 5000K
- Dimmable (Required Dimmer)
- Recommend Dimmer: Lutron #DVCL-153P
- Electronic Driver: Input 110-120V, output DC 36-54V
- Defogger
- Luminaire Disconnect
- Changeable LED Strip Light
- Primary Material: SPCC+GLASS
- UL Approved

FINISHES: Glossy White Back box

INSTALLATION:

1. Mount the chassis on the wall, the chassis can be horizontal and vertical hanging.
2. Install lamps
3. Wiring
4. Power connection
5. Hang mirror on chassis

Size: W20" X H30" X D1.58"

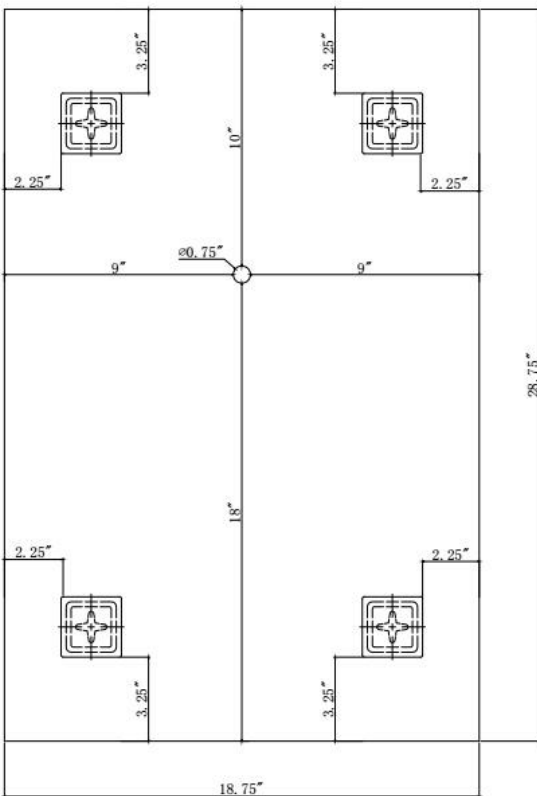

LABELS: UL/CUL listed (CUL listed number: E352423), ETL/CETL listed (ETL listed number: 3194213), IP Rating: IP44.